



Next Step To Future

DVX30 AT

3.0 Ton Diesel Forklift
with Automatic Transmission

CEV-V



Why Buy Me?

- ✓ BS-V (CEV-V) Emission Compliance
- ✓ Advanced Engine Technology
- ✓ Enhanced Durability & Performance
- ✓ Versatile Applications
- ✓ Smart Exhaust & Regeneration System
- ✓ Future Ready & Value For Money

Indian make engine options
- Cost & Service friendly
Mahindra MTorque
Service Engine

6

World Class technology
from KION in Driveline
and it's performance
characteristics

5

Modern looking forklift
suitable for current
generation operators

4



1 100% MADE IN INDIA

2 3000 KG full load
capacity at MFH -
Highest in its class
(option)

3 Best Maneuverability
& highest level of
Safety standards

SALIENT FEATURES



Mast Section for
wide and clear
visibility



Larger Tyres for better
road grip and stability



Powerful CEV-V
compliant Diesel Engine



Diesel Oxidation Catalyst
(DOC) + Diesel Particulate
Filter (DPF)



Ergonomic Operating
Lever for ease of
maintenance



Combination Lights for
clear and safe operation

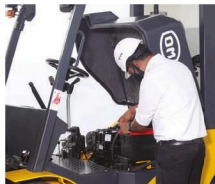

Large Engine Hood Space
for easy maintenance



Ample operator legroom
for operator comfort



Wider foot rest for safer
entry and exit



Front Cowl Assembly
protects all pipings
and hoses

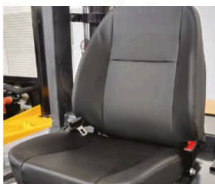

Ergonomic design of
seating for better
operator comfort



Single Electric Gear
Shift Lever



Easy access
combination switch



Elegant IP65 protected
Display

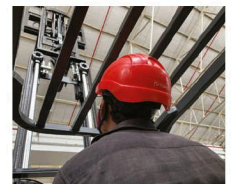

Clear Visibility at MFH

DVX AT - SPECIFICATIONS



Characteristics	1.1	Manufacturer	-	KION India
	1.2	Model Designation	-	DVX30 AT
	1.3	Power Unit: Battery/Diesel	-	Diesel
	1.4	Operation: Manual, Stan-On, Seated	-	Seated
	1.5	Load Capacity	Q(kg)	3000
	1.6	Load Center	C(mm)	500
	1.7	Axle Center to Fork Face	X(mm)	470
	1.8	Wheelbase	Y(mm)	1725
Weight	2.1	Service Weight - Laden/Unladen	kg	4100*
Wheels & Tyres	3.1	Tyre: Solid, Pneumatic, Superelastic	-	Solid
	3.2	Tyre: Size, Front	-	28x9-15
	3.3	Tyre: Size, Rear	-	6.50x10
	3.4	Wheels, Number Front/Rear (x=drive)	-	2/2
	3.5	Track Width, Front	b10 mm	950
Dimensions	3.6	Track Width, Rear	b11 mm	930
	4.1	Mast Tilt, Forward/Backward	a/?	Refer Table*
	4.2	Mast Height, Lowered	h1 mm	Refer Table*
	4.3	Freelift	h2 mm	Refer Table*
	4.4	Maximum Fork Height	h3 mm	Refer Table*
	4.5	Mast Height, Extended	h4 mm	Refer Table*
	4.6	Height of Overhead Guard	h6 mm	2150
	4.7	Overall Length	L1 mm	3900
	4.8	Length to Fork Face	L2 mm	2820
	4.9	Overall Width	b1 mm	1220
	4.10	Fork Dimensions	s/e/l mm	45x125x1070
	4.11	Fork Carriage to DIN 15173, Class/Form A,B	-	3A
	4.12	Width of Fork Carriage	b3 mm	1000
	4.13	Fork Spread (Out to Out)	s1/s2	220/930 265/965
	4.14	Ground Clearance Mast	m1 mm	125
	4.15	Ground Clearance, Center of Wheels	m2 mm	165
	4.16	Turning Radius	Wa mm	2550
Performance	5.1	Travel Speed, With/Without Load	km/h	16/16
	5.2	Lifting Speed, With/Without Load	m/s	0.5/0.55
	5.3	Lowering Speed, With/Without Load	m/s	0.5/0.35
	5.4	Gradability, With/Without Load	%	20/24
	5.5	Service Brake	-	Hydraulic
	5.6	Steering Type	-	Power Steering
Drive	6.1	Engine Manufacturer/ Type	-	Mahindra Mtorque 4485 MCDHC29NA047CE5
	6.2	Engine/Motor Performance	HP/Kw	48.5/36.2
	6.3	Rated Speed	rpm	2200 ± 50
	6.4	Max Torque	Nm@rpm	200 ± 5% @ 1200-1500
	6.5	No. of Cylinders		4
	6.6	Fuel Consumption as per VDI Cycle	l/h	NA
	6.7	Battery Voltage/Rated Capacity	v/Ah	12V/90AH
	6.8	Transmission Make/Model	-	KION
	6.9	Transmission Type	-	Automatic
	6.10	Gear Shift Type	-	Electric Shift
	6.11	Transmission Speed	Fwd/Rev	1/1

Stability as per 'BIS'. All specification are subjected to tolerance of ±12% except those governed by BIS.

Due to continuous improvements the dimensions are subjected to change without notice.

* Dimensions mentioned are for HVT 2125 Model, refer table for other mast configuration.

Gradability 20/24 % achieved without stop/start braking condition and gradability 17/20 % is achieved with stop/start braking condition.

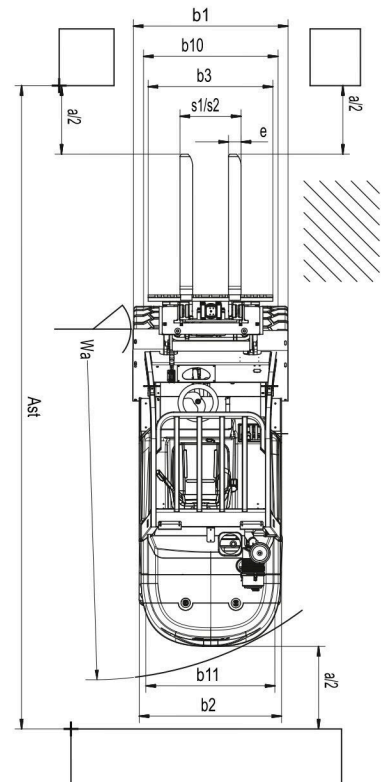
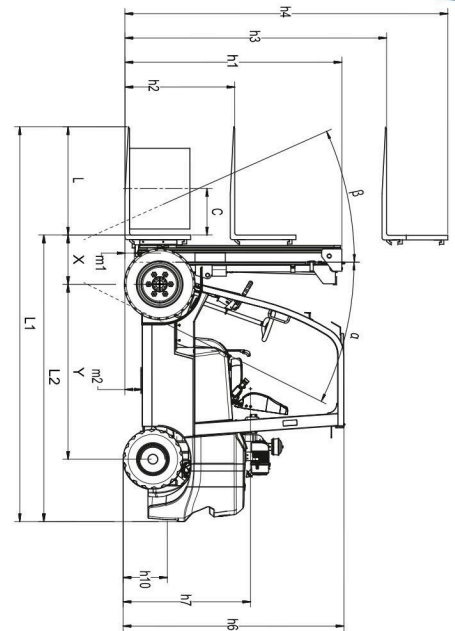

DERATION CHART								
Sr. No.	MAST Type	OAH h1 (mm)	FFH h2 (mm)	MFH h3 (mm)	OAH at MFH h4 (mm)	Tilt FWD/REV α/β	Capacity (kg) at 3000mm	Derated Capacity (kg) at MFH
1	HVM STD	2360	NIL	3620	4230	6°/12°	3000	3000
2	HVT 2125	2125	1465	4500	5105	6°/8°	3000	2750
3	HVT 2600	2600	2085	6030	6640	6°/6°	3000	1500

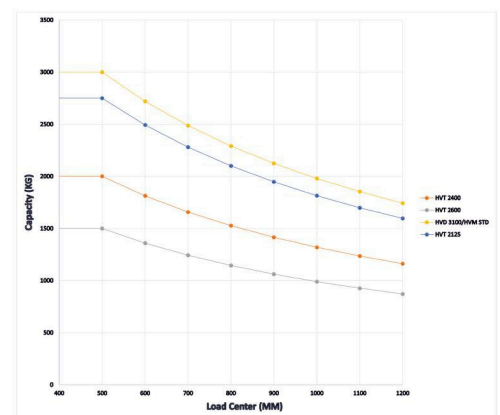

MANUFACTURING



India's largest and most Modern Material Handling Equipment Manufacturing Facility



Dedicated Assembly Line for MHE



Modern Paintshop



Advanced Quality Testing Facilities

CUSTOMER SUPPORT

We are a young and energetic team who are committed towards growing long-term engagement through our products and aftersales services. With quick and consistent support provided through the lifecycle, we ensure the maximum utility of the equipment.

Our support network is present across PAN India even at the remotest locations offering swift resolution to all product related queries, support on parts and services to our customers. Also, we offer various service contracts to minimize the downtime through our 100+ customer touchpoints.

135+ CUSTOMER TOUCH POINTS FOR SALE AND SERVICE



OM BRAND HERITAGE



OM is a captive brand, short form of Officine Meccaniche. Started in 1917 with the division of cars, and in 1937 forayed into forklift trucks. KION Group, In 2006, OM was unified with KION Group. Since its introduction in 2017 in India, OM brand products have been well appreciated as the preferred material handling equipment.



Address: KION India Private Limited, Gat No. 134/1, Vadhu Road, Off Pune Nagar Road, Koregaon Bhima, Taluka Shirur, District Pune 412216.

Email: in.enquiries@kiongroup.com | Website: www.om-mh.com

TOLL FREE NUMBER- 1800 270 1123